

Standard variant for network applications – polyphase systems, switching applications 250 V and low voltage

Application example

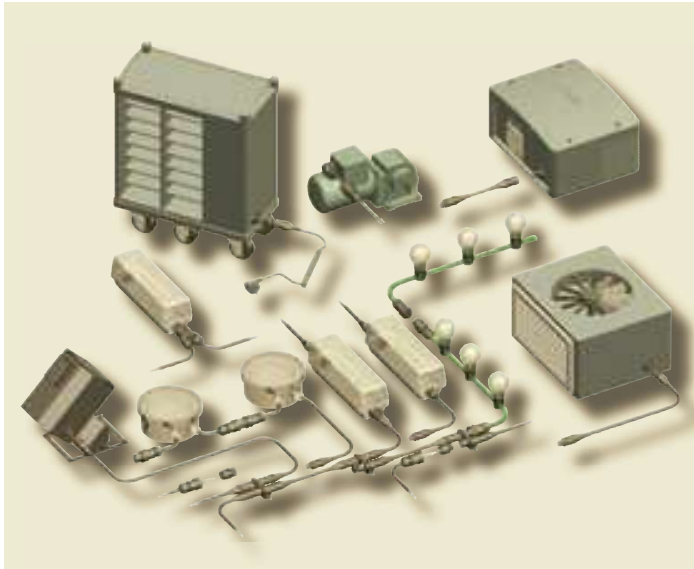

General

With the 3-pole connectors, there are four available variants: the standard variant for general network applications, one for extra-low voltage up to 50V with ground conductor, one for switching applications up to 250V and a green coding for applications in polyphase systems.

All connectors are mechanically coded. This means that only associated pairs of male and female can be connected with the correct polarity. You therefore have the security of a clear separation of different applications without having to redo any incorrect connections.

The color of the connectors indicates the links that belong together.

Coding

For daily updates visit the website at http://eshop.wieland-electric.com . Assembly instructions and other technical information can be found in the Technical Data or in eShop.					Application				
					Power 250V L, N, ⊕	Power 250/400V 1, 2, ⊕	Extra-low voltage signals bus 50V 1, 2, ⊕	Switch function 250V 1, 2, 3	
					Mechanical coding, for example				
Name	Description	Connection style	Strain relief housing	Connection points per pole	gray	black	green	brown	light blue
Connector	1 x cable entry	Screw Spring clamp Crimp	yes	1	✓	✓	✓	✓	✓
	2 x cable entry	Screw Spring clamp Crimp	yes	2	✓	✓	✓		
Distribution units	Distribution block 11/30				✓	✓	✓	✓	✓
	RST compact distribution unit / multi-distribution unit				on request	on request	on request	on request	on request
	Individual distribution box				on request	on request	on request	on request	on request
Device connectors	M16 device connector, modular, straight				✓	✓	✓	✓	✓
	M16 device connector, modular, angled 7°				✓	✓	✓	✓	✓
	M25 device connector, standard				✓	✓	✓	✓	✓
	M20 device connector, standard				✓	✓	✓	✓	✓
	M20 device connector, modular, angled				✓	✓	✓	✓	✓
	M25 device connector, modular, angled				✓	✓	✓	✓	✓
Cable assemblies	Connection cable Male – Free end	pre-assembled	pre-assembled	pre-assembled	✓	✓	✓	✓	
	Connection cable Female – Free end	pre-assembled	pre-assembled	pre-assembled	✓	✓	✓	✓	
	Extension cable Male – Female	pre-assembled	pre-assembled	pre-assembled	✓	✓	✓	✓	
	Connection cable Schuko – Female	pre-assembled	pre-assembled	pre-assembled	✓	✓			

Connectors, straight for cables Ø 6 – 10 mm and 10 – 14 mm

Female connector

Unmounted with cable gland.

See the Technical Data for insulation strip lengths as well as the ferrules to be used.

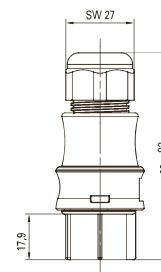
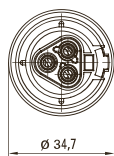

with spring clamp conn.		with screw connection ¹⁾		with crimp connection	
Wire	mm ²	Wire	mm ²	Wire	mm ²
rigid	0.5 – 2.5	rigid		fine-stranded	0.75 – 4.0
fine-stranded	0.5 – 1.5	fine-stranded	0.75 – 6.0 ²⁾	stranded	
stranded	0.75 – 1.5	stranded			

Application	Coding	Cable diameter in mm	Color	Part No.	Part No.	Part No.
Power 250 V		6 – 10	gray	96.031.0053.0	96.031.4053.0	96.131.0053.0
		10 – 14	black	96.031.0053.1	96.031.4053.1	96.131.0053.1
Power 250/400 V		6 – 10	gray	96.031.0153.0	96.031.4153.0	96.131.0153.0
		10 – 14	black	96.031.0153.1	96.031.4153.1	96.131.0153.1
Extra-low voltage		6 – 10	green	96.031.0055.7	96.031.4055.7	
		10 – 14	green	96.031.0155.7	96.031.4155.7	
Switch,func. 250 V		6 – 10	brown	96.031.0051.4	96.031.4051.4	
		10 – 14	brown	96.031.0151.4	96.031.4151.4	
Switch,func. 250 V		6 – 10	light blue	96.031.0053.9	96.031.4053.9	
		10 – 14	light blue	96.031.0153.9	96.031.4153.9	

Fine-stranded and stranded wires **only with ferrules** (see accessories)

Fine-stranded and stranded wires **without ferrules**

Contacts separately under Accessories.

Male connector

Unmounted with cable gland and locking device.

See the Technical Data for insulation strip lengths as well as the ferrules to be used.

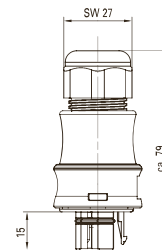
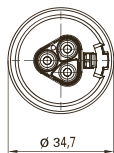

with spring clamp conn.		with screw connection ¹⁾		with crimp connection	
Wire	mm ²	Wire	mm ²	Wire	mm ²
rigid	0.5 – 2.5	rigid		fine-stranded	0.75 – 4.0
fine-stranded	0.5 – 1.5	fine-stranded	0.75 – 6.0 ²⁾	stranded	
stranded	0.75 – 1.5	stranded			

Application	Coding	Cable diameter in mm	Color	Part No.	Part No.	Part No.
Power 250 V		6 – 10	gray	96.032.0053.0	96.032.4053.0	96.132.0053.0
		10 – 14	black	96.032.0053.1	96.032.4053.1	96.132.0053.1
Power 250/400 V		6 – 10	gray	96.032.0153.0	96.032.4153.0	96.132.0153.0
		10 – 14	black	96.032.0153.1	96.032.4153.1	96.132.0153.1
Extra-low voltage		6 – 10	green	96.032.0055.7	96.032.4055.7	
		10 – 14	green	96.032.0155.7	96.032.4155.7	
Extra-low voltage		6 – 10	brown	96.032.0051.4	96.032.4051.4	
		10 – 14	brown	96.032.0151.4	96.032.4151.4	
Switch,func. 250 V		6 – 10	light blue	96.032.0053.9	96.032.4053.9	
		10 – 14	light blue	96.032.0153.9	96.032.4153.9	

Fine-stranded and stranded wires **only with ferrules** (see accessories)

Fine-stranded and stranded wires **without ferrules**

Contacts separately under Accessories.

¹⁾ With wire protection available on request

²⁾ With 6.0 mm² wires the pull and bending forces at the connector must be taken into consideration and compensated by suitable measures if required

Connectors, angled 90° for cables Ø 6 – 10 mm and 10 – 14 mm

Female connector

Unmounted with cable gland.
90° angle.

See the Technical Data for insulation strip lengths as well as the ferrules to be used.

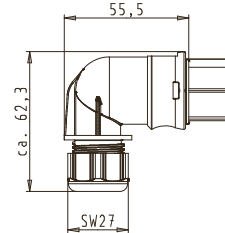
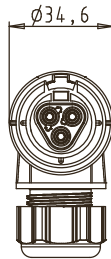

with spring clamp conn.		with screw connection ¹⁾		with crimp connection	
Wire	mm ²	Wire	mm ²	Wire	mm ²
rigid	0.5 – 2.5	rigid		fine-stranded	0.75 – 4.0
fine-stranded	0.5 – 1.5	fine-stranded	0.75 – 6.0 ²⁾		
stranded	0.75 – 1.5	stranded			

Application	Coding	Cable diameter in mm	Color	Part No.	Part No.	Part No.
Power 250 V		6 – 10	gray	96.033.0053.0	96.033.4053.0	96.133.0053.0
		10 – 14	black	96.033.0053.1	96.033.4053.1	96.133.0053.1
Power 250/400 V		6 – 10	gray	96.033.0153.0	96.033.4153.0	96.133.0153.0
		10 – 14	black	96.033.0153.1	96.033.4153.1	96.133.0153.1
Power 250/400 V		6 – 10	green	96.033.0055.7	96.033.4055.7	
		10 – 14	green	96.033.0155.7	96.033.4155.7	
Extra-low voltage		6 – 10	brown	96.033.0051.4	96.033.4051.4	
		10 – 14		96.033.0151.4	96.033.4151.4	
Switch,func. 250 V		6 – 10	light blue	96.033.0053.9	96.033.4053.9	
		10 – 14		96.033.0153.9	96.033.4153.9	

Fine-stranded and stranded wires **only with** ferrules (see accessories)

Fine-stranded and stranded wires **without** ferrules

Contacts separately under Accessories.

Male connector

Unmounted with cable gland and locking device. 90° angle.

See the Technical Data for insulation strip lengths as well as the ferrules to be used.

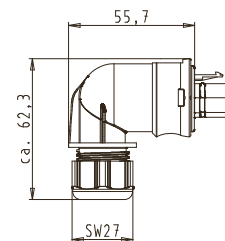

with spring clamp conn.		with screw connection ¹⁾		with crimp connection	
Wire	mm ²	Wire	mm ²	Wire	mm ²
rigid	0.5 – 2.5	rigid		fine-stranded	0.75 – 4.0
fine-stranded	0.5 – 1.5	fine-stranded	0.75 – 6.0 ²⁾		
stranded	0.75 – 1.5	stranded			

Application	Coding	Cable diameter in mm	Color	Part No.	Part No.	Part No.
Power 250 V		6 – 10	gray	96.034.0053.0	96.034.4053.0	96.134.0053.0
		10 – 14	black	96.034.0053.1	96.034.4053.1	96.134.0053.1
Power 250/400 V		6 – 10	gray	96.034.0153.0	96.034.4153.0	96.134.0153.0
		10 – 14	black	96.034.0153.1	96.034.4153.1	96.134.0153.1
Power 250/400 V		6 – 10	green	96.034.0055.7	96.034.4055.7	
		10 – 14	green	96.034.0155.7	96.034.4155.7	
Extra-low voltage		6 – 10	brown	96.034.0051.4	96.034.4051.4	
		10 – 14		96.034.0151.4	96.034.4151.4	
Switch,func. 250 V		6 – 10	light blue	96.034.0053.9	96.034.4053.9	
		10 – 14		96.034.0153.9	96.034.4153.9	

Fine-stranded and stranded wires **only with** ferrules (see accessories)

Fine-stranded and stranded wires **without** ferrules

Contacts separately under Accessories.

RST® CLASSIC

¹⁾ With wire protection available on request

²⁾ With 6.0 mm² wires the pull and bending forces at the connector must be taken into consideration and compensated by suitable measures if required

Connectors, straight for cables Ø 13 – 18 mm

Female connector

Unmounted with cable gland.

See Technical Data for sheath and insulation strip lengths.

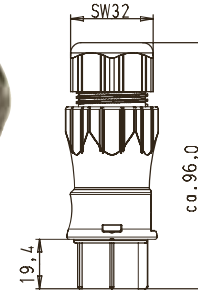

with screw connection¹⁾

Wire	mm ²	
rigid		
fine-stranded	0,75 – 6,0 ²⁾	without ferrules
stranded		without ferrules

with crimp connection

Wire	mm ²	
fine-stranded	0,75 – 4,0	

Application	Coding	Cable diameter in mm	Color
Power 250 V	L, N, ⊕	13 – 18	gray black
Power 250/400 V	1, 2, ⊕	13 – 18	green

Part No.
96.031.4553.0
96.031.4553.1
96.031.4555.7

Part No.
96.131.4553.0
96.131.4553.1

Fine-stranded and stranded wires **without ferrules**

Contacts separately under Accessories.

Male connector

Unmounted with cable gland and locking device.

See Technical Data for sheath and insulation strip lengths.

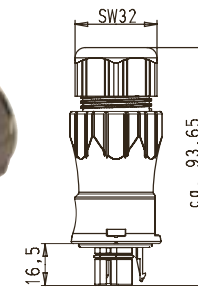

with screw connection¹⁾

Wire	mm ²	
rigid		
fine-stranded	0,75 – 6,0 ²⁾	without ferrules
stranded		without ferrules

with crimp connection

Wire	mm ²	
fine-stranded	0,75 – 4,0	

Application	Coding	Cable diameter in mm	Color
Power 250 V	N, L, ⊕	13 – 18	gray black
Power 250/400 V	2, 1, ⊕	13 – 18	green

Part No.
96.032.4553.0
96.032.4553.1
96.032.4555.7

Part No.
96.132.4553.0
96.132.4553.1

Fine-stranded and stranded wires **without ferrules**

Contacts separately under Accessories.

¹⁾ With wire protection available on request

²⁾ With 6,0 mm² wires the pull and bending forces at the connector must be taken into consideration and compensated by suitable measures if required

Splitter connector, straight for cables Ø 6 – 10 mm and 10 – 14 mm

Female connector

Unmounted with cable gland.

See the Technical Data for insulation strip lengths as well as the ferrules to be used.

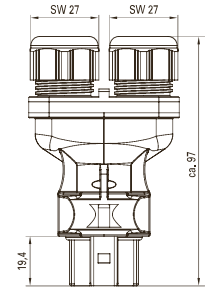
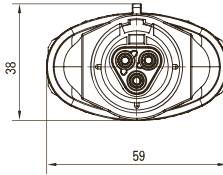

with spring clamp connection

Leitungen	mm ²	
rigid	0.5 – 2.5	
fine-stranded	0.5 – 1.5	with ferrules
stranded	0.75 – 1.5	with ferrules

with screw connection¹⁾

Leitungen	mm ²	
rigid		
fine-stranded	0.75 – 2.5	
stranded		

Application	Coding	Cable diameter in mm	Color
Power 250 V		6 – 10	gray black
		10 – 14	gray black
Power 250/400 V		6 – 10	green
Switch.func. 250 V		10 – 14	light blue

Part No.	
96.031.0253.0	
96.031.0253.1	
96.031.0353.0	
96.031.0353.1	
96.031.0255.7	
96.031.0355.7	
96.031.0353.9	

Fine-stranded and stranded wires **only** with ferrules (see accessories)

Part No.	
96.031.4253.0	
96.031.4253.1	
96.031.4353.0	
96.031.4353.1	
96.031.4255.7	
96.031.4355.7	

Fine-stranded and stranded wires **without** ferrules

Mounting plate for splitter connectors

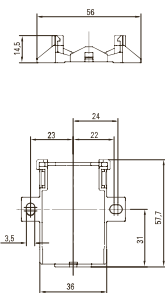

Color	Part No.
gray	01.006.1553.0
black	01.006.1553.1

¹⁾ With wire protection available on request

M25 device connector straight, standard

Female connector

Correct positioning guaranteed due to flattened thread. Fastening with screws from outside.

See the Technical Data for insulation strip lengths as well as the ferrules to be used.

For the spacer rings for unlocking the device connectors, see Accessories.

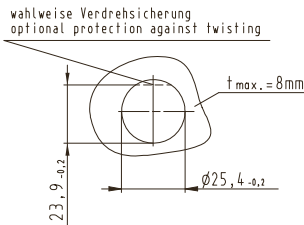
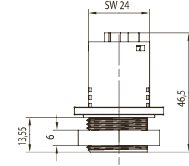
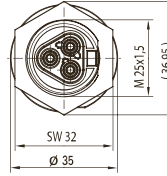

with spring clamp conn.

Wire	mm ²
rigid	0.5 – 2.5
fine-stranded	0.5 – 1.5
stranded	0.75 – 1.5
Term. poles	2
Thread	M25 x 1.5
Gland	outside

with screw connection

Wire	mm ²
rigid	
fine-stranded	0.75 – 6.0
stranded	
Term. poles	1
Thread	M25 x 1.5
Gland	outside

with crimp connection

Wire	mm ²
fine-stranded	0.75 – 4.0
Term. poles	1
Thread	M25 x 1.5
Gland	outside

Application	Coding	Color
Power 250 V	L, N, ⊕	gray black
Power 250/400 V	1, 2, ⊕	green
Extra-low voltage	1, 2, ⊕	brown
Switch.func. 250 V	1, 2, 3	light blue

Part No.
96.031.1053.0
96.031.1053.1
96.031.1055.7
96.031.1051.4
96.031.1053.9

Part No.
96.031.5053.0
96.031.5053.1
96.031.5055.7
96.031.5051.4
96.031.5053.9

Part No.
96.131.1053.0
96.131.1053.1

Fine-stranded and stranded wires **only with** ferrules (see accessories)

Fine-stranded and stranded wires **without** ferrules

Contacts separately under Accessories.

Male connector

Correct positioning guaranteed due to flattened thread. Fastening with screws from outside. With locking device.

See the Technical Data for insulation strip lengths.

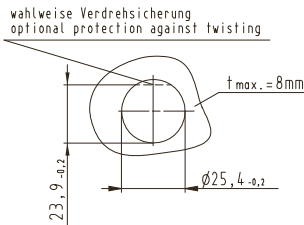
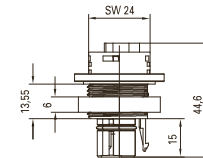
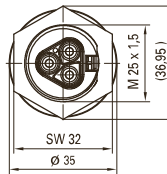

with spring clamp conn.

Wire	mm ²
rigid	0.5 – 2.5
fine-stranded	0.5 – 1.5
stranded	0.75 – 1.5
Term. poles	2
Thread	M25 x 1.5
Gland	outside

with screw connection

Wire	mm ²
rigid	
fine-stranded	0.75 – 6.0
stranded	
Term. poles	1
Thread	M25 x 1.5
Gland	outside

with crimp connection

Wire	mm ²
fine-stranded	0.75 – 4.0
Term. poles	1
Thread	M25 x 1.5
Gland	outside

Application	Coding	Color
Power 250 V	N, L, ⊕	gray black
Power 250/400 V	2, 1, ⊕	green
Extra-low voltage	2, 1, ⊕	brown
Switch.func. 250 V	2, 1, 3	light blue

Part No.
96.032.1053.0
96.032.1053.1
96.032.1055.7
96.032.1051.4
96.032.1053.9

Part No.
96.032.5053.0
96.032.5053.1
96.032.5055.7
96.032.5051.4
96.032.5053.9

Part No.
96.132.1053.0
96.132.1053.1

Fine-stranded and stranded wires **only with** ferrules (see accessories)

Fine-stranded and stranded wires **without** ferrules

Contacts separately under Accessories.

M20 device connector straight, modular

Female connector

Correct positioning guaranteed due to flattened thread. Fastening with screws from inside.

See the Technical Data for insulation strip lengths as well as the ferrules to be used.

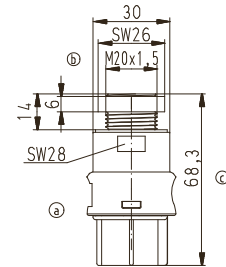
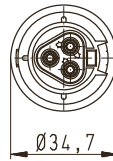

wahlweise Verdrehsicherung
optional protection against twisting

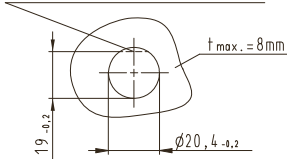

with spring clamp connection

Wire	mm ²
rigid	0.5 – 2.5
fine-stranded	0.5 – 1.5
stranded	0.75 – 1.5
Term. poles	2
Thread	M20 x 1.5
Gland	inside

with screw connection

Wire	mm ²
rigid	
fine-stranded	0.75 – 6.0
stranded	
Term. poles	1
Thread	M20 x 1.5
Gland	inside

with crimp connection

Wire	mm ²
fine-stranded	0.75 – 4.0
Term. poles	1
Thread	M20 x 1.5
Gland	inside

Application	Coding	Color
Power 250 V	L, N, ⊕	gray black
Power 250/400 V	1, 2, ⊕	green
Extra-low voltage	1, 2, ⊕	brown
Switch.func. 250 V	1, 2, 3	light blue

Part No.
96.031.2053.0
96.031.2053.1
96.031.2055.7
96.031.2051.4
96.031.2053.9

Part No.
96.031.6053.0
96.031.6053.1
96.031.6055.7
96.031.6051.4
96.031.6053.9

Part No.
96.131.2053.0
96.131.2053.1

Fine-stranded and stranded wires **only with ferrules** (see accessories)

Fine-stranded and stranded wires **without ferrules**

Contacts separately under Accessories.

Male connector

Correct positioning guaranteed due to flattened thread. Fastening with screws from inside. With locking device.

See the Technical Data for insulation strip lengths.

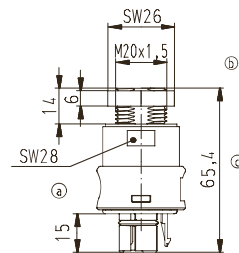
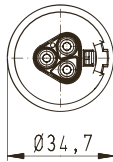

wahlweise Verdrehsicherung
optional protection against twisting

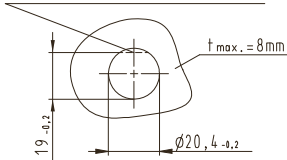

with spring clamp connection

Wire	mm ²
rigid	0.5 – 2.5
fine-stranded	0.5 – 1.5
stranded	0.75 – 1.5
Term. poles	2
Thread	M20 x 1.5
Gland	inside

with screw connection

Wire	mm ²
rigid	
fine-stranded	0.75 – 6.0
stranded	
Term. poles	1
Thread	M20 x 1.5
Gland	inside

with crimp connection

Wire	mm ²
fine-stranded	0.75 – 4.0
Term. poles	1
Thread	M20 x 1.5
Gland	inside

Application	Coding	Color
Power 250 V	N, L, ⊕	gray black
Power 250/400 V	2, 1, ⊕	green
Extra-low voltage	2, 1, ⊕	brown
Switch.func. 250 V	2, 1, 3	light blue

Part No.
96.032.2053.0
96.032.2053.1
96.032.2055.7
96.032.2051.4
96.032.2053.9

Part No.
96.032.6053.0
96.032.6053.1
96.032.6055.7
96.032.6051.4
96.032.6053.9

Part No.
96.132.2053.0
96.132.2053.1

Fine-stranded and stranded wires **only with ferrules** (see accessories)

Fine-stranded and stranded wires **without ferrules**

Contacts separately under Accessories.

RST® CLASSIC

M16 device connector straight, modular

Female connector

Correct positioning guaranteed due to flattened thread. Fastening with screws from inside.

See the Technical Data for insulation strip lengths as well as the ferrules to be used.

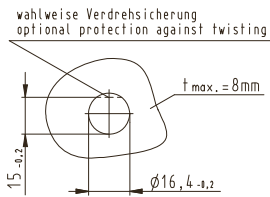
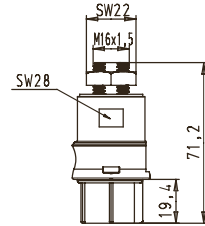

with spring clamp connection	with screw connection	with crimp connection
Wire mm ²	Wire mm ²	Wire mm ²
rigid 0.5 – 2.5	rigid 0.75 – 6.0	fine-stranded 0.75 – 4.0
fine-stranded 0.5 – 1.5	fine-stranded 0.75 – 6.0	Term. poles 1
stranded 0.75 – 1.5	stranded 0.75 – 6.0	Thread M16 x 1.5
Term. poles 2	Term. poles 1	Gland inside
Thread M16 x 1.5	Thread M16 x 1.5	
Gland inside	Gland inside	

Application	Coding	Color
Power 250 V	L, N, ⊕	gray black
Power 250/400 V	1, 2, ⊕	green
Extra-low voltage	1, 2, ⊕	brown
Switch,func. 250 V	1, 2, 3	light blue

Part No.
96.031.2153.0
96.031.2153.1
96.031.2155.7
96.031.2151.4
96.031.2153.9

Part No.
96.031.6153.0
96.031.6153.1
96.031.6155.7
96.031.6151.4
96.031.6153.9

Part No.
96.131.2153.0
96.131.2153.1

Fine-stranded and stranded wires **only with** ferrules (see accessories)

Fine-stranded and stranded wires **without** ferrules

Contacts separately under Accessories.

Male connector

Correct positioning guaranteed due to flattened thread. Fastening with screws from inside. With locking device.

See the Technical Data for insulation strip lengths.

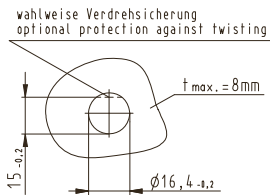
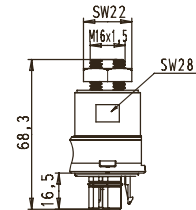

with spring clamp connection	with screw connection	with crimp connection
Wire mm ²	Wire mm ²	Wire mm ²
rigid 0.5 – 2.5	rigid 0.75 – 6.0	fine-stranded 0.75 – 4.0
fine-stranded 0.5 – 1.5	fine-stranded 0.75 – 6.0	Term. poles 1
stranded 0.75 – 1.5	stranded 0.75 – 6.0	Thread M16 x 1.5
Term. poles 2	Term. poles 1	Gland inside
Thread M16 x 1.5	Thread M16 x 1.5	
Gland inside	Gland inside	

Application	Coding	Color
Power 250 V	N, L, ⊕	gray black
Power 250/400 V	2, 1, ⊕	green
Extra-low voltage	2, 1, ⊕	brown
Switch,func. 250 V	2, 1, 3	light blue

Part No.
96.032.2153.0
96.032.2153.1
96.032.2155.7
96.032.2151.4
96.032.2153.9

Part No.
96.032.6153.0
96.032.6153.1
96.032.6155.7
96.032.6151.4
96.032.6153.9

Part No.
96.132.2153.0
96.132.2153.1

Fine-stranded and stranded wires **only with** ferrules (see accessories)

Fine-stranded and stranded wires **without** ferrules

Contacts separately under Accessories.

M16 device connector angled 7°, modular

Female connector

Correct positioning guaranteed due to flattened thread. Fastening with screws from inside. Angled 7°, thread M16.

See the Technical Data for insulation strip lengths as well as the ferrules to be used.

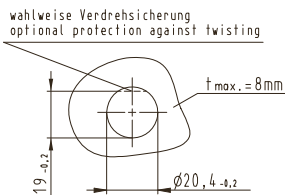
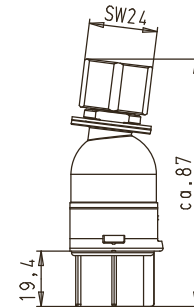

with spring clamp connection

Wire	mm ²
rigid	0.5 – 2.5
fine-stranded	0.5 – 1.5
stranded	0.75 – 1.5
Term. poles	2
Thread	M16 x 1.5
Gland	inside

with screw connection

Wire	mm ²
rigid	
fine-stranded	0.75 – 6.0
stranded	
Term. poles	1
Thread	M16 x 1.5
Gland	inside

with crimp connection

Wire	mm ²
fine-stranded	0.75 – 4.0
Term. poles	1
Thread	M16 x 1.5
Gland	inside

Application	Coding	Color
Power 250 V	L, N, ⊕	gray black
Power 250/400 V	1, 2, ⊕	green
Extra-low voltage	1, 2, ⊕	brown
Switch,func. 250 V	1, 2, 3	light blue

Part No.
96.035.2153.0
96.035.2153.1
96.035.2155.7
96.035.2151.4
96.035.2153.9

Part No.
96.035.6153.0
96.035.6153.1
96.035.6155.7
96.035.6151.4
96.035.6153.9

Part No.
96.135.2153.0
96.135.2153.1

Fine-stranded and stranded wires **only with** ferrules (see accessories)

Fine-stranded and stranded wires **without** ferrules

Contacts separately under Accessories.

Male connector

Correct positioning guaranteed due to flattened thread. Fastening with screws from inside. With locking device. Angled 7°, thread M16.

See the Technical Data for insulation strip lengths.

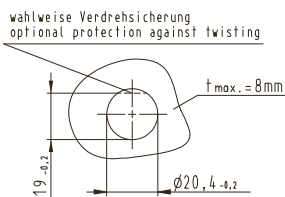
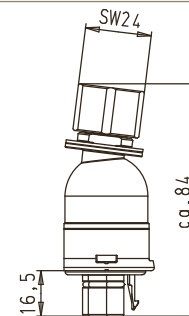

with spring clamp connection

Wire	mm ²
rigid	0.5 – 2.5
fine-stranded	0.5 – 1.5
stranded	0.75 – 1.5
Term. poles	2
Thread	M16 x 1.5
Gland	inside

with screw connection

Wire	mm ²
rigid	
fine-stranded	0.75 – 6.0
stranded	
Term. poles	1
Thread	M16 x 1.5
Gland	inside

with crimp connection

Wire	mm ²
fine-stranded	0.75 – 4.0
Term. poles	1
Thread	M16 x 1.5
Gland	inside

Application	Coding	Color
Power 250 V	N, L, ⊕	gray black
Power 250/400 V	2, 1, ⊕	green
Extra-low voltage	2, 1, ⊕	brown
Switch,func. 250 V	2, 1, 3	light blue

Part No.
96.036.2153.0
96.036.2153.1
96.036.2155.7
96.036.2151.4
96.036.2153.9

Part No.
96.036.6153.0
96.036.6153.1
96.036.6155.7
96.036.6151.4
96.036.6153.9

Part No.
96.136.2153.0
96.136.2153.1

Fine-stranded and stranded wires **only with** ferrules (see accessories)

Fine-stranded and stranded wires **without** ferrules

Contacts separately under Accessories.

M20 device connector angled 90°, modular

Female connector

Correct positioning guaranteed due to flattened thread. Fastening with screws from inside.

See the Technical Data for insulation strip lengths as well as the ferrules to be used.

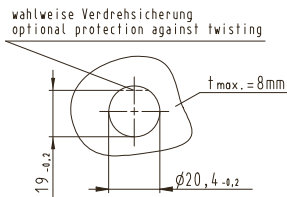
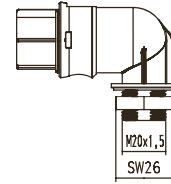
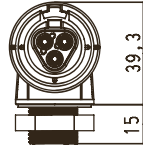

with spring clamp connection

Wire	mm ²
rigid	0.5 – 2.5
fine-stranded	0.5 – 1.5
stranded	0.75 – 1.5
Term. poles	2
Thread	M20 x 1.5
Gland	inside

with screw connection

Wire	mm ²
rigid	
fine-stranded	0.75 – 6.0
stranded	
Term. poles	1
Thread	M20 x 1.5
Gland	inside

with crimp connection

Wire	mm ²
fine-stranded	0.75 – 4.0
Term. poles	1
Thread	M20 x 1.5
Gland	inside

Application	Coding	Color
Power 250 V	L, N, ⊕	gray black
Power 250/400 V	1, 2, ⊕	green
Extra-low voltage	1, 2, ⊕	brown
Switch,func. 250 V	1, 2, 3	light blue

Part No.
96.033.2053.0
96.033.2053.1
96.033.2055.7
96.033.2051.4
96.033.2053.9

Part No.
96.033.6053.0
96.033.6053.1
96.033.6055.7
96.033.6051.4
96.033.6053.9

Part No.
96.133.2053.0
96.133.2053.1

Fine-stranded and stranded wires **only with** ferrules (see accessories)

Fine-stranded and stranded wires **without** ferrules

Contacts separately under Accessories.

Male connector

Correct positioning guaranteed due to flattened thread. Fastening with screws from inside. With locking device.

See the Technical Data for insulation strip lengths.

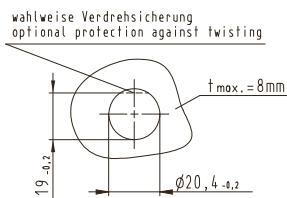
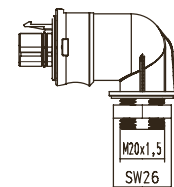
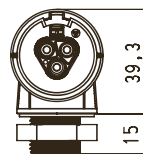

with spring clamp connection

Wire	mm ²
rigid	0.5 – 2.5
fine-stranded	0.5 – 1.5
stranded	0.75 – 1.5
Term. poles	2
Thread	M20 x 1.5
Gland	inside

with screw connection

Wire	mm ²
rigid	
fine-stranded	0.75 – 6.0
stranded	
Term. poles	1
Thread	M20 x 1.5
Gland	inside

with crimp connection

Wire	mm ²
fine-stranded	0.75 – 4.0
Term. poles	1
Thread	M20 x 1.5
Gland	inside

Application	Coding	Color
Power 250 V	N, L, ⊕	gray black
Power 250/400 V	2, 1, ⊕	green
Extra-low voltage	2, 1, ⊕	brown
Switch,func. 250 V	2, 1, 3	light blue

Part No.
96.034.2053.0
96.034.2053.1
96.034.2055.7
96.034.2051.4
96.034.2053.9

Part No.
96.034.6053.0
96.034.6053.1
96.034.6055.7
96.034.6051.4
96.034.6053.9

Part No.
96.134.2053.0
96.134.2053.1

Fine-stranded and stranded wires **only with** ferrules (see accessories)

Fine-stranded and stranded wires **without** ferrules

Contacts separately under Accessories.

M25 device connector angled 90°, modular

Female connector

Correct positioning guaranteed due to flattened thread. Fastening with screws from inside.

See the Technical Data for insulation strip lengths as well as the ferrules to be used.

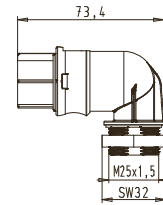
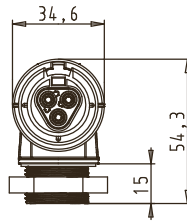

wahlweise Verdrehsicherung
optional protection against twisting

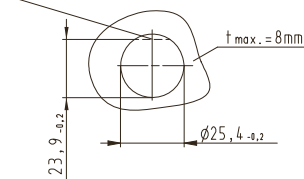

with spring clamp connection

Wire	mm ²
rigid	0.5 – 2.5
fine-stranded	0.5 – 1.5
stranded	0.75 – 1.5
Term. poles	2
Thread	M25 x 1.5
Gland	inside

with screw connection

Wire	mm ²
rigid	
fine-stranded	0.75 – 6.0
stranded	
Term. poles	1
Thread	M25 x 1.5
Gland	inside

with crimp connection

Wire	mm ²
fine-stranded	0.75 – 4.0
Term. poles	1
Thread	M25 x 1.5
Gland	inside

Application	Coding	Color
Power 250 V	L, N, ⊕	gray black
Power 250/400 V	1, 2, ⊕	green
Extra-low voltage	1, 2, ⊕	brown
Switch,func. 250 V	1, 2, 3	light blue

Part No.
96.033.2253.0
96.033.2253.1
96.033.2255.7
96.033.2251.4
96.033.2253.9

Part No.
96.033.6253.0
96.033.6253.1
96.033.6255.7
96.033.6251.4
96.033.6253.9

Part No.
96.133.2253.0
96.133.2253.1

Fine-stranded and stranded wires **only with** ferrules (see accessories)

Fine-stranded and stranded wires **without** ferrules

Contacts separately under Accessories.

Male connector

Correct positioning guaranteed due to flattened thread. Fastening with screws from inside. With locking device.

See the Technical Data for insulation strip lengths.

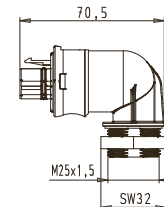
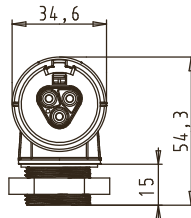

wahlweise Verdrehsicherung
optional protection against twisting

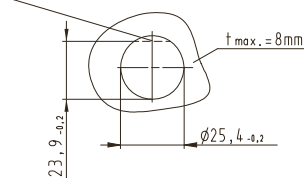

with spring clamp connection

Wire	mm ²
rigid	0.5 – 2.5
fine-stranded	0.5 – 1.5
stranded	0.75 – 1.5
Term. poles	2
Thread	M25 x 1.5
Gland	inside

with screw connection

Wire	mm ²
rigid	
fine-stranded	0.75 – 6.0
stranded	
Term. poles	1
Thread	M25 x 1.5
Gland	inside

with crimp connection

Wire	mm ²
fine-stranded	0.75 – 4.0
Term. poles	1
Thread	M25 x 1.5
Gland	inside

Application	Coding	Color
Power 250 V	N, L, ⊕	gray black
Power 250/400 V	2, 1, ⊕	green
Extra-low voltage	2, 1, ⊕	brown
Switch,func. 250 V	2, 1, 3	light blue

Part No.
96.034.2253.0
96.034.2253.1
96.034.2255.7
96.034.2251.4
96.034.2253.9

Part No.
96.034.6253.0
96.034.6253.1
96.034.6255.7
96.034.6251.4
96.034.6253.9

Part No.
96.134.2253.0
96.134.2253.1

Fine-stranded and stranded wires **only with** ferrules (see accessories)

Fine-stranded and stranded wires **without** ferrules

Contacts separately under Accessories.

RST® CLASSIC

Cable assemblies

Cable 3 x 1.5 mm²; 16 A

Rated values			Pull relief	shrinkage tube
Wire ends	(open cable end)	ultrason. welded	Interlock	integrated
Sheath strip length	(open cable end)	35 mm	Color cable	black
Wire strip length	(open cable end)	9 mm	Color shrinkage tube	black

Connection cables female – male

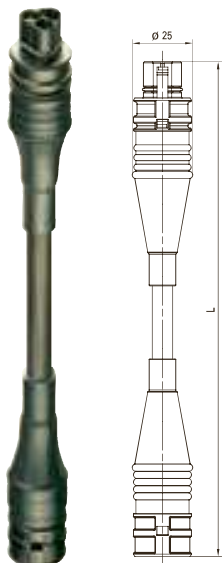

Cable	Length m	Part No.	Part No.
PVC cable H05VV-F containing halogen	1	96.232.1000.1	96.232.1001.7
	2	96.232.2000.1	96.232.2001.7
	3	96.232.3000.1	96.232.3001.7
	4	96.232.4000.1	96.232.4001.7
	5	96.232.5000.1	96.232.5001.7
	6	96.232.6000.1	96.232.6001.7
	7	96.232.7000.1	96.232.7001.7
	8	96.232.8000.1	96.232.8001.7

Cable	Length m	Part No.	Part No.	Part No.
Rubber-sheathed cable H07RN-F containing halogen	1	96.232.1030.1	96.232.1031.7	on request
	2	96.232.2030.1	96.232.2031.7	
	3	96.232.3030.1	96.232.3031.7	
	4	96.232.4030.1	96.232.4031.7	
	5	96.232.5030.1	96.232.5031.7	
	6	96.232.6030.1	96.232.6031.7	
	7	96.232.7030.1	96.232.7031.7	
	8	96.232.8030.1	96.232.8031.7	

Cable	Length m	Part No.
Rubber-sheathed cable H07RN-F enhanced version halogen-free	1	96.232.1050.1
	2	96.232.2050.1
	3	96.232.3050.1
	4	96.232.4050.1
	5	96.232.5050.1
	6	96.232.6050.1
	7	96.232.7050.1
	8	96.232.8050.1

Connection cables female – free end

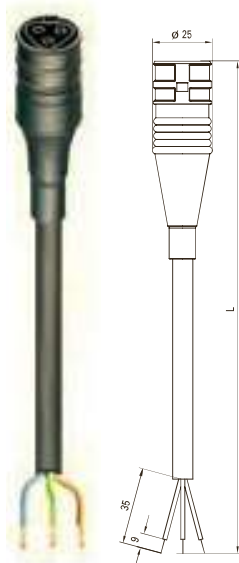

Cable	Length m	Part No.	Part No.
PVC cable H05VV-F containing halogen	1	96.232.1003.1	96.232.1005.7
	2	96.232.2003.1	96.232.2005.7
	3	96.232.3003.1	96.232.3005.7
	4	96.232.4003.1	96.232.4005.7
	5	96.232.5003.1	96.232.5005.7
	6	96.232.6003.1	96.232.6005.7
	7	96.232.7003.1	96.232.7005.7
	8	96.232.8003.1	96.232.8005.7

Cable	Length m	Part No.	Part No.	Part No.
Rubber-sheathed cable H07RN-F containing halogen	1	96.232.1033.1	96.232.1035.7	on request
	2	96.232.2033.1	96.232.2035.7	
	3	96.232.3033.1	96.232.3035.7	
	4	96.232.4033.1	96.232.4035.7	
	5	96.232.5033.1	96.232.5035.7	
	6	96.232.6033.1	96.232.6035.7	
	7	96.232.7033.1	96.232.7035.7	
	8	96.232.8033.1	96.232.8035.7	

Cable	Length m	Part No.
Rubber-sheathed cable H07RN-F enhanced version halogen-free	1	96.232.1053.1
	2	96.232.2053.1
	3	96.232.3053.1
	4	96.232.4053.1
	5	96.232.5053.1
	6	96.232.6053.1
	7	96.232.7053.1
	8	96.232.8053.1

Cable assemblies

Cable 3 x 1.5 mm²; 16 A

Connection cables male – free end

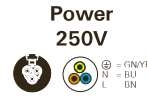
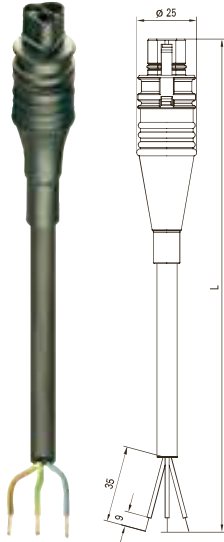

Cable	Length m	Part No.	Part No.
PVC cable H05VV-F containing halogen	1	96.232.1004.1	96.232.1006.7
	2	96.232.2004.1	96.232.2006.7
	3	96.232.3004.1	96.232.3006.7
	4	96.232.4004.1	96.232.4006.7
	5	96.232.5004.1	96.232.5006.7
	6	96.232.6004.1	96.232.6006.7
	7	96.232.7004.1	96.232.7006.7
	8	96.232.8004.1	96.232.8006.7

Cable	Length m	Part No.	Part No.	Part No.
Rubber-sheathed cable H07RN-F containing halogen	1	96.232.1034.1	96.232.1036.7	on request
	2	96.232.2034.1	96.232.2036.7	
	3	96.232.3034.1	96.232.3036.7	
	4	96.232.4034.1	96.232.4036.7	
	5	96.232.5034.1	96.232.5036.7	
	6	96.232.6034.1	96.232.6036.7	
	7	96.232.7034.1	96.232.7036.7	
	8	96.232.8034.1	96.232.8036.7	

Cable	Length m	Part No.
Rubber-sheathed cable H07RN-F enhanced version halogen-free	1	96.232.1054.1
	2	96.232.2054.1
	3	96.232.3054.1
	4	96.232.4054.1
	5	96.232.5054.1
	6	96.232.6054.1
	7	96.232.7054.1
	8	96.232.8054.1

Power Connection cable

Male: european standard (SKII) – female: **RST®**

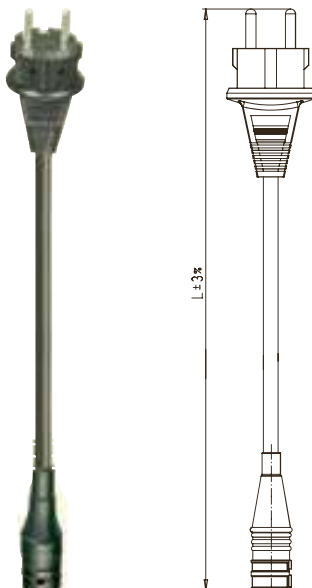

Power 250V
Color: gray

Cable	Length m	Part No.
PVC cable H05VV-F containing halogen	1.5	99.714.0000.7
	2.5	99.715.0000.7

Power 250V
Color: black

Cable	Length m	Part No.
Rubber-sheathed cable H07RN-F containing halogen	1.5	99.712.0000.7
	2.5	99.713.0000.7
	4	99.716.0000.7
	5	99.718.0000.7
	8	99.717.0000.7

RST® CLASSIC

Cable assemblies

Cable 3 x 2.5 mm²; 20 A

Rated values			Pull relief	shrinkage tube
Wire ends	(open cable end)	ultrason. welded	Interlock	integrated
Sheath strip length	(open cable end)	35 mm	Color cable	black
Wire strip length	(open cable end)	9 mm	Color shrinkage tube	black

Connection cables female – male

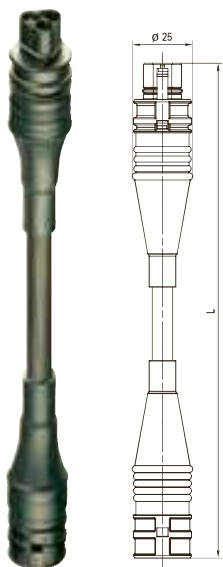

Cable	Length m	Part No.	
		Power 250V	Power 250V / 400V
PVC cable H05VV-F containing halogen	1	96.233.1000.1	96.233.1001.7
	2	96.233.2000.1	96.233.2001.7
	3	96.233.3000.1	96.233.3001.7
	4	96.233.4000.1	96.233.4001.7
	5	96.233.5000.1	96.233.5001.7
	6	96.233.6000.1	96.233.6001.7
	7	96.233.7000.1	96.233.7001.7
	8	96.233.8000.1	96.233.8001.7

Cable	Length m	Part No.	
		Power 250V	Power 250V / 400V
Rubber-sheathed cable H07RN-F containing halogen	1	96.233.1030.1	96.233.1031.7
	2	96.233.2030.1	96.233.2031.7
	3	96.233.3030.1	96.233.3031.7
	4	96.233.4030.1	96.233.4031.7
	5	96.233.5030.1	96.233.5031.7
	6	96.233.6030.1	96.233.6031.7
	7	96.233.7030.1	96.233.7031.7
	8	96.233.8030.1	96.233.8031.7

Cable	Length m	Part No.	
		Power 250V	Power 250V / 400V
Rubber-sheathed cable H07RN-F enhanced version halogen-free	1	96.233.1050.1	
	2	96.233.2050.1	
	3	96.233.3050.1	
	4	96.233.4050.1	
	5	96.233.5050.1	
	6	96.233.6050.1	
	7	96.233.7050.1	
	8	96.233.8050.1	

Connection cables female – free end

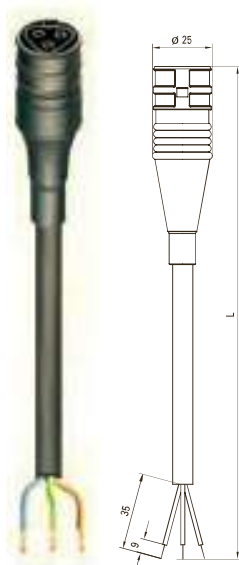

Cable	Length m	Part No.	
		Power 250V	Power 250V / 400V
PVC cable H05VV-F containing halogen	1	96.233.1003.1	96.233.1005.7
	2	96.233.2003.1	96.233.2005.7
	3	96.233.3003.1	96.233.3005.7
	4	96.233.4003.1	96.233.4005.7
	5	96.233.5003.1	96.233.5005.7
	6	96.233.6003.1	96.233.6005.7
	7	96.233.7003.1	96.233.7005.7
	8	96.233.8003.1	96.233.8005.7

Cable	Length m	Part No.	
		Power 250V	Power 250V / 400V
Rubber-sheathed cable H07RN-F containing halogen	1	96.233.1033.1	96.233.1035.7
	2	96.233.2033.1	96.233.2035.7
	3	96.233.3033.1	96.233.3035.7
	4	96.233.4033.1	96.233.4035.7
	5	96.233.5033.1	96.233.5035.7
	6	96.233.6033.1	96.233.6035.7
	7	96.233.7033.1	96.233.7035.7
	8	96.233.8033.1	96.233.8035.7

Cable	Length m	Part No.	
		Power 250V	Power 250V / 400V
Rubber-sheathed cable H07RN-F enhanced version halogen-free	1	96.233.1053.1	
	2	96.233.2053.1	
	3	96.233.3053.1	
	4	96.233.4053.1	
	5	96.233.5053.1	
	6	96.233.6053.1	
	7	96.233.7053.1	
	8	96.233.8053.1	

Cable assemblies

Cable 3 x 2.5 mm²; 20 A

Connection cables male – free end

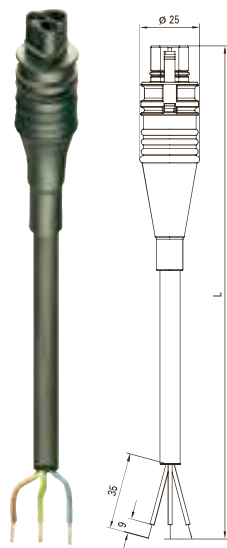

Cable	Length m	Part No.	Part No.
PVC cable H05VV-F containing halogen	1	96.233.1004.1	96.233.1006.7
	2	96.233.2004.1	96.233.2006.7
	3	96.233.3004.1	96.233.3006.7
	4	96.233.4004.1	96.233.4006.7
	5	96.233.5004.1	96.233.5006.7
	6	96.233.6004.1	96.233.6006.7
	7	96.233.7004.1	96.233.7006.7
	8	96.233.8004.1	96.233.8006.7

Cable	Length m	Part No.	Part No.
Rubber-sheathed cable H07RN-F containing halogen	1	96.233.1034.1	96.233.1036.7
	2	96.233.2034.1	96.233.2036.7
	3	96.233.3034.1	96.233.3036.7
	4	96.233.4034.1	96.233.4036.7
	5	96.233.5034.1	96.233.5036.7
	6	96.233.6034.1	96.233.6036.7
	7	96.233.7034.1	96.233.7036.7
	8	96.233.8034.1	96.233.8036.7

Cable	Length m	Part No.
Rubber-sheathed cable H07RN-F enhanced version halogen-free	1	96.233.1054.1
	2	96.233.2054.1
	3	96.233.3054.1
	4	96.233.4054.1
	5	96.233.5054.1
	6	96.233.6054.1
	7	96.233.7054.1
	8	96.233.8054.1

Distribution units

Distribution block 11/30

Interlock

Yes

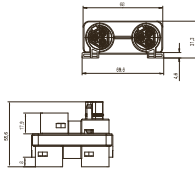
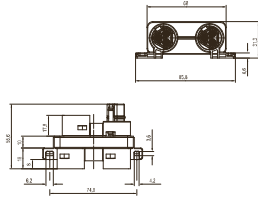

with fastening option

Color	Application	Pole marking	Input	Outputs	Part No.
■ black	Power 250 V	L, N, PE	1	3	96.030.0153.1
■ light grey	Power 250 V	L, N, PE	1	3	96.030.0153.0
■ green	Power 250 V/400 V	1, 2, PE	1	3	96.030.0155.7
■ brown	50 V + PE	1, 2, PE	1	3	96.030.0151.4

without fastening option

Color	Application	Pole marking	Input	Outputs	Part No.
■ black	Power 250 V	L, N, PE	1	3	96.030.0253.1
■ light grey	Power 250 V	L, N, PE	1	3	96.030.0253.0
■ green	Power 250 V/400 V	1, 2, PE	1	3	96.030.0255.7
■ brown	50 V + PE	1, 2, PE	1	3	96.030.0251.4

Circuit diagram

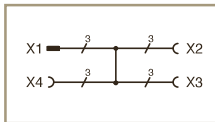

RST compact distribution unit 11/30

Dimensions

104 x 162 x 57.2 mm

fitted as required with
pre-wired with
Mounting option

M25 device connectors 3-pole
2.5 mm² (halogen free)
Yes



Circuit diagram

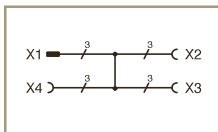

Color	Application	Pole marking	Input	Outputs	Part No.
■ black			1, RST20i3	3, RST20i3	99.906.0000.7

RST multi-distribution unit 11/70

Dimensions

104 x 162 x 96 mm

fitted as required with
pre-wired with
Fuse

M25 device connectors 3-pole
2.5 mm² (halogen free)
6.3 or 10A can be integrated



Circuit diagram

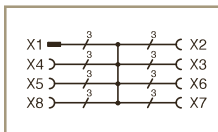

Color	Application	Pole marking	Input	Outputs	Part No.
■ black			1, RST20i3	7, RST20i3	99.929.0000.7

Accessories

Cover pieces

For the safe closure of female and male connectors.

With mounting strap for snapping onto plug connectors and device connectors

for female



for male

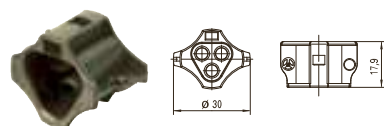

not captive against loss

Color	for female	for male
■ gray	Part No. Z5.564.4553.0	Part No. 05.564.4453.0
■ black	Z5.564.4553.1	05.564.4453.1

for female

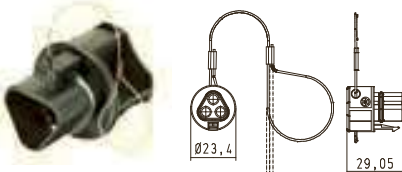

for male

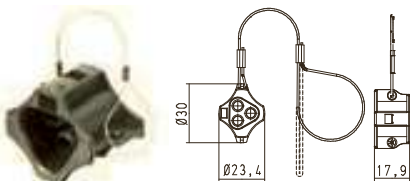

captive against loss

Color	for female	for male
■ gray	Part No. 99.413.6205.2	Part No. 99.415.6205.2
■ black	99.414.6205.2	99.416.6205.2

Socket frame for device connectors M25 (female)

Protection rating: IP 44
 RST approval: 2PFG1915, EN61535
 Entry: 2- up to 5-pole

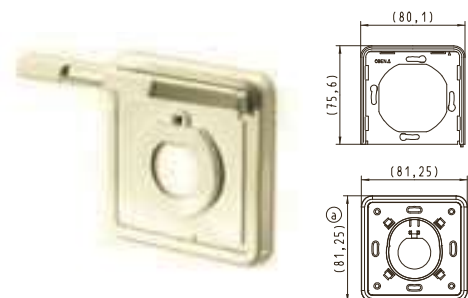

Color	Part No.
□ white	99.400.9999.7



RST® CLASSIC