

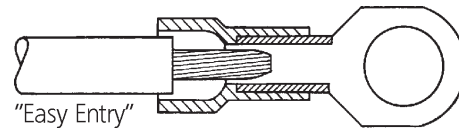

Insulated cable lugs



Benefits

- EASY-ENTRY funnel shape of the plastic sleeve enables simple, fast and safe insertion of the conductor
- No risk of bent and crushed cables
- For good strength and improved current conduction

Application range

- Manufacturing of control cabinets and equipment

Product features

- Hard-soldered cable lug that can be pressed in any position
- For first-class connection with simple operating principle
- Electrolytic tinning for max. corrosion protection
- Flat receptacle material in contact pressing is double-folded and hard-soldered
- Metal sleeves with internal corrugation

Norm references / Approvals

- Tested in accordance with DIN IEC 60352
- File Number E334109, see table

Note

- Butt connector: Solid conductors and fine stranded wires and diverse cross-sections can be crimped together

Design

- 1 = ring cable lugs
- 2 = forked cable lugs
- 3 = pin cable lugs
- 4 = circular connector
- 5 = connector sleeve
- 6 = butt connector
- 7 = end connector (see pictures- from left to right)

Suitable tools

- DSA 0110 + DSA 0725 crimping pliers refer to page 1008
- CSA 0760 + KSA 0760 crimping pliers refer to page 1008

Technical data

Classification ETIM 5/6
 ETIM 5.0/6.0 Class-ID: EC001052
 ETIM 5.0/6.0 Class-Description: Solderless copper terminals for copper conductors

General
 Other sizes and colours (also DIN) are available upon request
 Halogen-free

Note
 For processing tools see the keyword index "crimping pliers for other connections"

Material
 High-quality electrolytic copper for good conductivity
 Polyamide insulation

Temperature range
 -20°C to +105°C
 Short-term: up to +120°C

Article number	Article designation	For mm ²	UL certification	Connection bolt	Core colour	Pieces / PU
Ring cable lugs						
63104010	L-RZ 3	0.25 - 0.75	no	M 3	green	100
63104020	L-RZ 4	0.25 - 0.75	no	M 4	green	100
63104030	L-RZ 5	0.25 - 0.75	no	M 5	green	100
63104040	L-RA 3	0.5 - 1.5	yes	M 3	red	100
63104050	L-RA 35	0.5 - 1.5	yes	M 3.5	red	100
63104060	L-RA 4	0.5 - 1.5	yes	M 4	red	100
63104070	L-RA 5	0.5 - 1.5	yes	M 5	red	100
63104080	L-RA 6	0.5 - 1.5	yes	M 6	red	100
63104160	L-RB 3	1.5 - 2.5	yes	M 3	blue	100
63104170	L-RB 4	1.5 - 2.5	yes	M 4	blue	100
63104180	L-RB 5	1.5 - 2.5	yes	M 5	blue	100
63104190	L-RB 6	1.5 - 2.5	yes	M 6	blue	100
63104200	L-RB 8	1.5 - 2.5	yes	M 8	blue	100
63104340	L-RC 4	4 - 6	yes	M 4	yellow	100
63104350	L-RC 5	4 - 6	yes	M 5	yellow	50
63104360	L-RC 6	4 - 6	yes	M 6	yellow	50
63104370	L-RC 8	4 - 6	yes	M 8	yellow	100
63104380	L-RC 10	4 - 6	yes	M 10	yellow	50
Fork cable lugs						
63105010	L-RZ 3 F	0.25 - 0.75	no	M 3	green	100
63105020	L-RZ 4 F	0.25 - 0.75	no	M 4	green	100
63105050	L-RA 4 F	0.5 - 1.5	yes	M 4	red	100
63105060	L-RA 5 F	0.5 - 1.5	yes	M 5	red	100
63105070	L-RA 6 F	0.5 - 1.5	yes	M 6	red	100
63105130	L-RB 4 F	1.5 - 2.5	yes	M 4	blue	100
63105140	L-RB 5 F	1.5 - 2.5	yes	M 5	blue	100
63105150	L-RB 6 F	1.5 - 2.5	yes	M 6	blue	100
63105210	L-RC 4 F	4 - 6	yes	M 4	yellow	100
63105220	L-RC 5 F	4 - 6	yes	M 5	yellow	100
63105230	L-RC 6 F	4 - 6	yes	M 6	yellow	50
63105040	L-RA 35 F	0.5 - 1.5	yes	M 3.5	red	100
63105110	L-RB 3 F	1.5 - 2.5	yes	M 3	blue	100
63105120	L-RB 35 F	1.5 - 2.5	yes	M 3.5	blue	100
Flange fork cable lugs						
63108010	L-RA 35 FF	0.5 - 1.5	no	M 3.5	red	100
63108040	L-RB 4 FF	1.5 - 2.5	no	M 4	blue	100
63108050	L-RB 5 FF	1.5 - 2.5	no	M 5	blue	100

Article number	Article designation	For mm ²	UL certification	Connection bolt	Core colour	Pieces / PU
Pin cable lugs						
63107010	L-RZP	0.25 - 0.75	no		green	100
63107020	L-RAP	0.5 - 1.5	yes		red	100
63107040	L-RBP	1.5 - 2.5	yes		blue	100
63107070	L-RCP	4 - 6	yes		yellow	100
Circular connector						
63110010	L-RABM	0.5 - 1.5	no		red	100
63110020	L-RB 5 BM	1.5 - 2.5	no		blue	100
Connector sleeve						
63111010	L-RAB	0.5 - 1.5	no		red	100
63111020	L-RB 5 B	1.5 - 2.5	no		blue	100
Butt connector						
63106020	L-RAA 15	0.5 - 1.5	yes		red	100
63106040	L-RBB 25	1.5 - 2.5	yes		blue	100
63106080	L-RCC 6	4 - 6	yes		yellow	50
End joint						
63112010	L-RBJ	1.5 - 2.5	no		transparent	100
63112020	L-RCJ	4 - 6	no		transparent	50

Other sizes and colours are available upon request.
 Photographs and graphics are not to scale and do not represent detailed images of the respective products.
 Production tolerance ± 0,5 mm

Solderless cable lugs KB

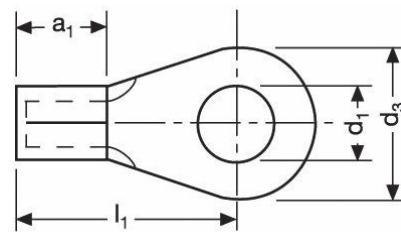

Benefits

- For first-class connection with simple operating principle
- Thus providing the best electrical conductivity (least resistance)

Application range

- For cables with category 2,5 and 6 conductors
- Manufacturing of control cabinets and equipment
- Trains and buses

Norm references / Approvals

- In accordance with VG 88710
- Coil form DIN 46234, non-insulated

Note

- For processing tools see the keyword index "crimping pliers for other connections"

Suitable tools

- PEW 12 universal tool refer to page 1019
- V 1311-A pressing pliers, hydraulic refer to page 1014
- DKB 0325 + DKB 0360 crimping pliers refer to page 1010

Technical data

Classification ETIM 5/6
 ETIM 5.0/6.0 Class-ID: EC001052
 ETIM 5.0/6.0 Class-Description: Solderless copper terminals for copper conductors

Note
 s = thickness of material

Material
 High-quality electrolytic copper for good conductivity

Temperature range
 Max. temperature: +120°C (short-term)
 Temperature range up to +90°C

Article number	Article designation	For mm ²	UL certification	AWG	Nominal size	d1	d3	l1	a1	s	Pieces / PU
Solderless cable lugs KB											
63204015	KB1-2,5R DIN 46234	0.5 - 1.5	no	22-16	2.5-1.0	2.8	6	11	5		100
63204025	KB1-3R DIN 46234	0.5 - 1.5	no	22-16	3.2-1.0	3.2	6	11	5	0.8	100
63204035	KB1-3,5R DIN 46234	0.5 - 1.5	no	22-16	3.5-1.0	3.7	6	11	5	0.8	100
63204045	KB1-4R DIN 46234	0.5 - 1.5	no	22-16	4.0-1.0	4.3	8	12	5	0.8	100
63204055	KB1-5R DIN 46234	0.5 - 1.5	no	22-16	5.0-1.0	5.3	10	13	5	0.8	100
63204065	KB1-6R DIN 46234	0.5 - 1.5	no	22-16	6.0-1.0	6.5	10	13	5	0.8	100
63204075	KB1-8R DIN 46234	0.5 - 1.5	no	22-16	8.0-1.0	8.4	14	17	5	0.8	100
63204085	KB1-10R DIN 46234	0.5 - 1.5	no	22-16	10.0-1.0	10.5	14	17	5	0.8	100
63204095	KB2,5-3R DIN 46234	1.5 - 2.5	no	16-14	3.0-2.5	3.2	6	11	5	0.8	100
63204105	KB2,5-3,5R DIN 46234	1.5 - 2.5	no	16-14	3.5-2.5	3.7	6	11	5	0.8	100
63204115	KB2,5-4R DIN 46234	1.5 - 2.5	no	16-14	4.0-2.5	4.3	8	12	5	0.8	100
63204125	KB2,5-5R DIN 46234	1.5 - 2.5	no	16-14	5.0-2.5	5.3	10	14	5	0.8	100
63204135	KB2,5-6R DIN 46234	1.5 - 2.5	no	16-14	6.0-2.5	6.5	11	16	5	0.8	100